

SEE DRW 5048976-AR-02-1018
FOR OTHER HALF OF PLAN

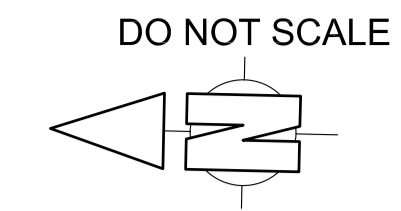

COMMERCIAL IN CONFIDENCE

1. REFERENCE DESIGN DRAWING TO BE READ IN CONJUNCTION WITH EMPLOYERS REQUIREMENTS, REFERENCE DESIGN SPECIFICATIONS AND ALL OTHER ARCHITECTURAL DRAWINGS
2. REFERENCE DESIGN DRAWING FOR PRICING PURPOSES ONLY
3. SPECIFIED PRODUCTS SHALL BE EQUAL OR APPROVED

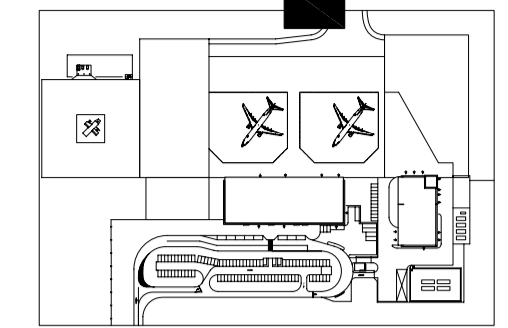

DRAWING MUST BE VIEWED/ REPRODUCED IN COLOUR

Floor and Wall Finishes

- Acoustic Timber Panel
See 5817 -> Architecture for Airport Buildings - Section K13 for details
 - Painted Plasterboard
See 5817 -> Architecture for Airport Buildings - Section K10/M60 for details
 - Painted Blockwork
See 5817 -> Architecture for Airport Buildings - Section F10/M60 for details
 - Ceramic Tiling
See 5817 -> Architecture for Airport Buildings - Section M40 for details
 - Frameless Glazing
See 5817 -> Architecture for Airport Buildings - Section H13 for details
-
- Sealed Concrete
See 5817 -> Architecture for Airport Buildings - Section E41 and relevant structural specifications for details
 - Vinyl
See 5817 -> Architecture for Airport Buildings - Section M50 for details
 - Linoleum
See 5817 -> Architecture for Airport Buildings - Section M50 for details
 - Carpet Tiles
See 5817 -> Architecture for Airport Buildings - Section M50 for details
 - Conglomerate Stone
See 5817 -> Architecture for Airport Buildings - Section M40 for details
 - Ceramic Floor Tiles
See 5817 -> Architecture for Airport Buildings - Section M40 for details

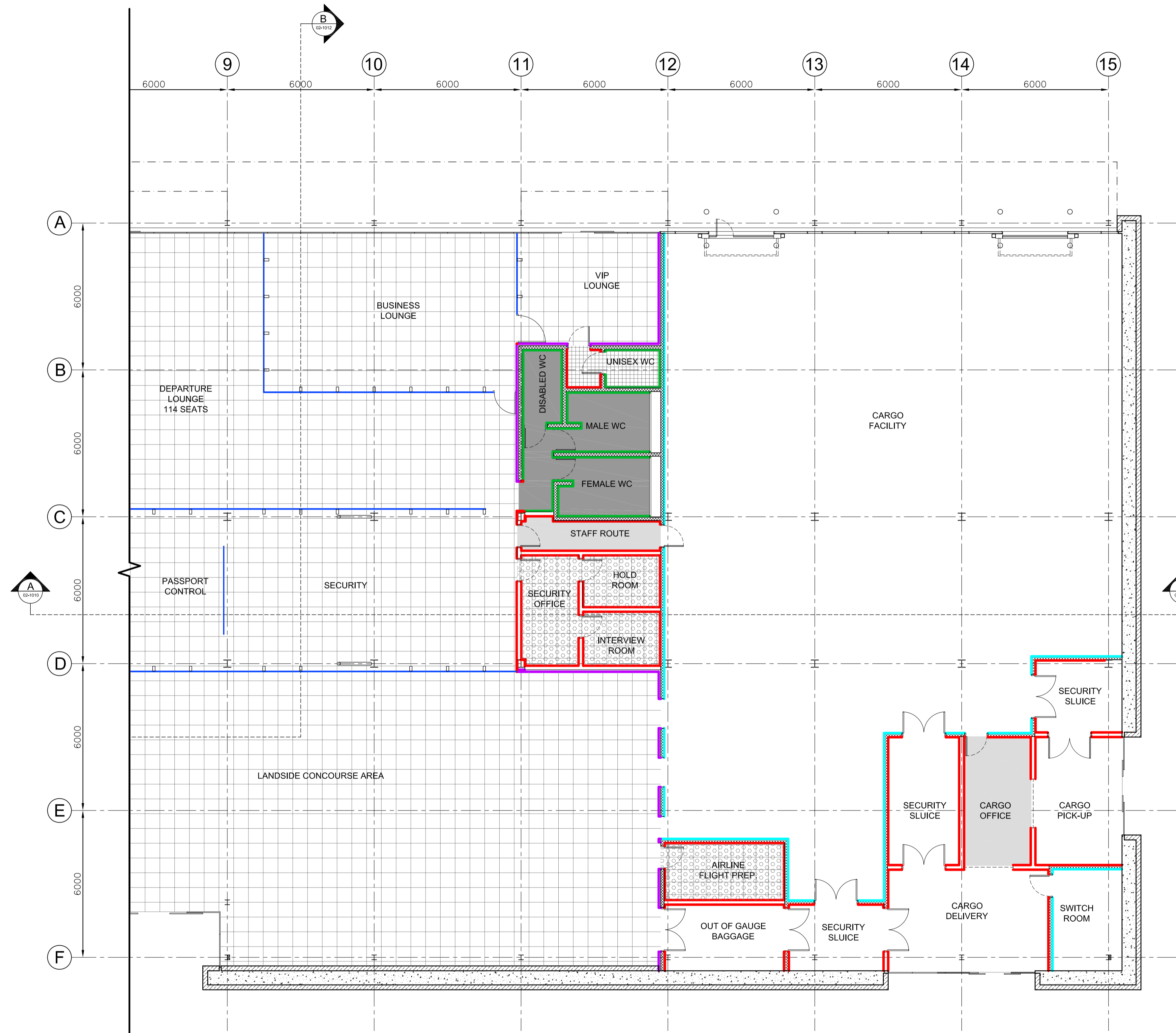

B	MINOR REVISION	MAC	11/04/07	MJW	RDJ
A	MINOR REVISION	MAC	21/02/07	MJW	RDJ
Rev.	Description	By	Date	Chk'd	Auth
T	TENDER	A	21/02/07		RDJ
R	PRICING & REVIEW	-	26/01/07		RDJ
Code	Purpose of issue	Rev	Date	Authorised	

Client
DFID

Consultant
Atkins Limited
Consulting Engineers,
Woodcote Grove,
Ashley Road,
Epsom, Surrey, England,
KT18 5BW
www: <http://www.atkinsglobal.com>
Fax (01372) 740055
Tel. (01372) 726140

Project
St Helena Reference Design

Title
**TERMINAL
General Arrangement
Floor & Wall Finishes
2 of 2**

Scale at A1	Drawn	Checked	Authorised	Status
1:100	MAC	GH	RDJ	T
	Date 26/01/07	Date 26/01/07	Date 26/01/07	

Drawing Number	Rev
5048976 - AR - 02 - 1019	B

